



TO ASSEMBLE THIS,
YOU'LL NEED THE
FOLLOWING TOOLS:

4MM ALLEN KEY
(THERE'LL BE ONE IN YOUR
TOOL BOX)

OR YOU MAY PREFER
TO USE AN ELECTRIC
OR BATTERY DRILL
WITH A 4MM ALLEN BIT

1

First, join two of the
leg frames together
using two of the
40mm M6 bolts.

2

Next, add the third leg
frame using four of the
40mm M6 bolts. Then
knock in the six domed
bungs on the ends of
all leg frames.

3

Lay the worksurface
upside down on the floor
and fix the assembled leg
frame to it using the bolts,
saddle washers and cover
caps as above.

4

Turn the table over and
give it a quick wipe.
Remember to consult
the LearningSurface®
care pack to look after
the dry-wipe top.

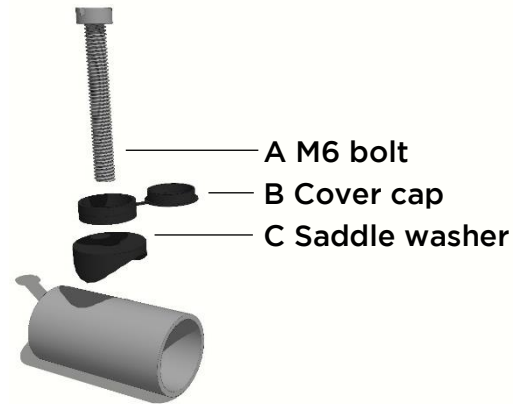

A 12 x 40mm M6 bolts
B 6 x cover caps
C 6 saddle washers
D 6 domed bungs

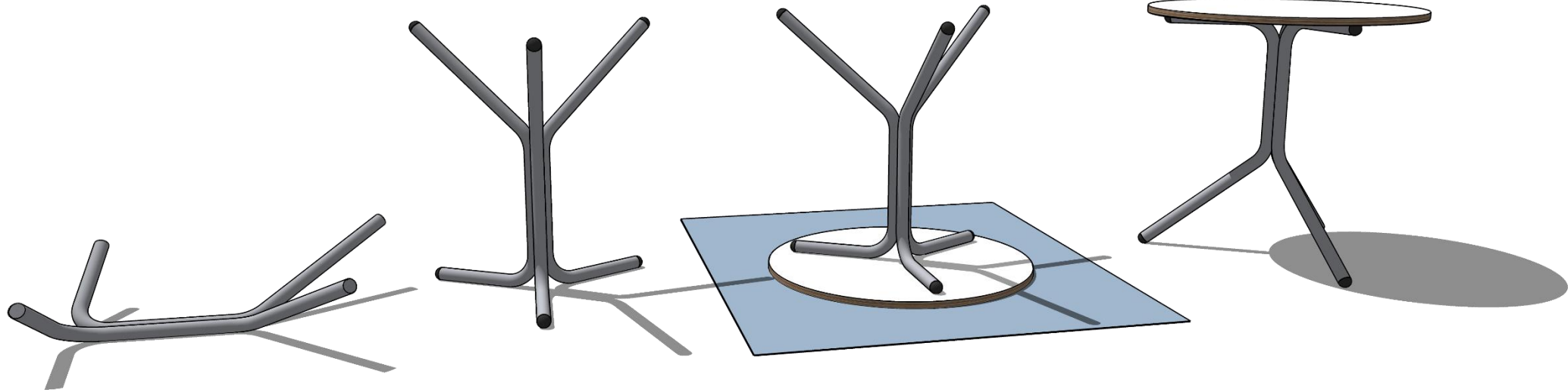
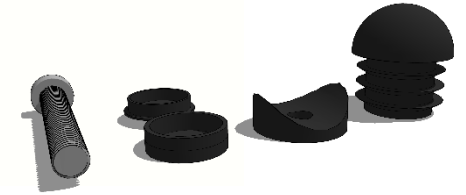

We recommend you put an old blanket or
something similar on the floor to make sure
you don't scratch the worksurface.

learniture

ASSEMBLY INSTRUCTIONS

THREE TIMES TABLE



learniture

www.learniture.co.uk
+44 (0) 1491 352152

3XT-INS R109/20