

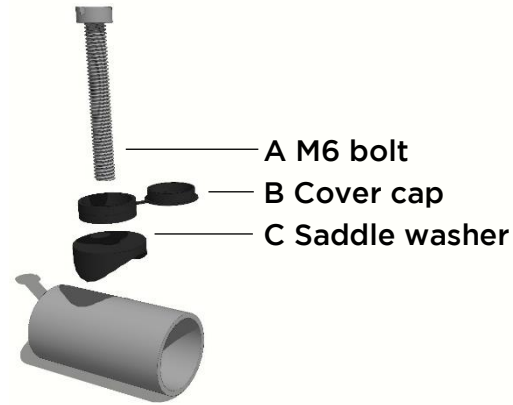

TO ASSEMBLE THIS,
YOU'LL NEED THE
FOLLOWING TOOLS:

4MM ALLEN KEY
(THERE'LL BE ONE IN YOUR
TOOL BOX)

OR YOU MAY PREFER
TO USE AN ELECTRIC
OR BATTERY DRILL
WITH A 4MM ALLEN BIT



A 6 x 40mm M6 bolts
B 6 x cover caps
C 6 saddle washers
D 3 'U' brackets
E 6 x 15mm M6 bolts

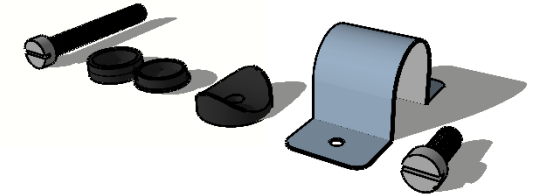

1

First, join one of the leg frames to the worksurface using two of the 40mm bolts, cover caps and saddle washers (as above) and using two of the 15mm bolts to secure the 'U' clip.

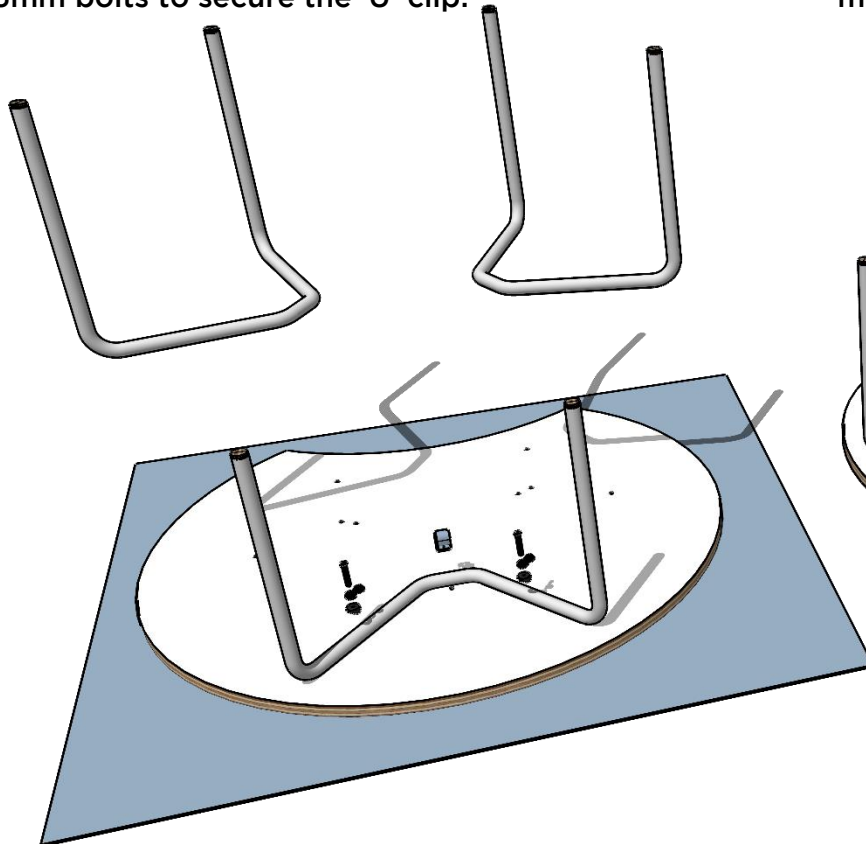

2

Next, add the second and third leg frames using the same method as before.

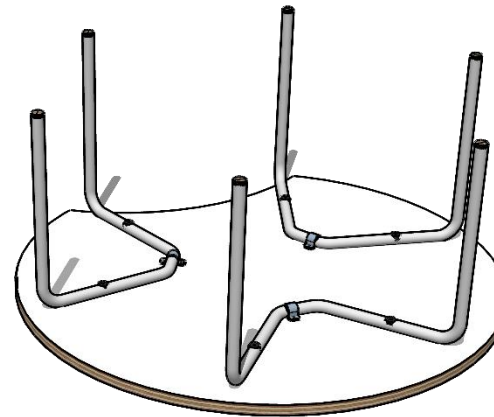

3

Turn the table over and give it a quick wipe. Remember to consult the LearningSurface® care pack to look after the dry-wipe top.

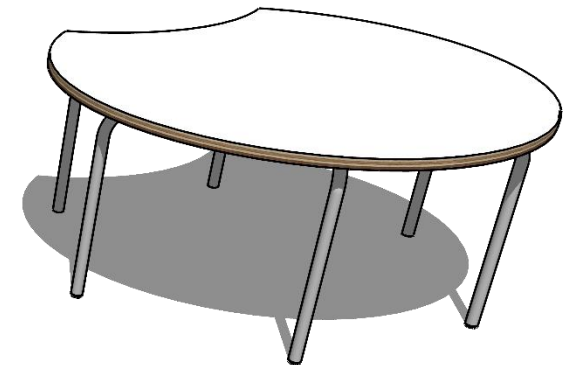

We recommend you put an old blanket or something similar on the floor to make sure you don't scratch the worksurface.

learniture

ASSEMBLY INSTRUCTIONS

BIG SMILE TABLE

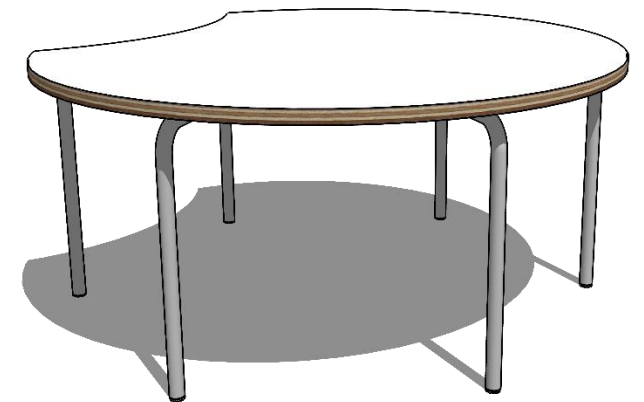

learniture

www.learniture.co.uk
+44 (0) 1491 352152

BIG-INS R1 06/21