

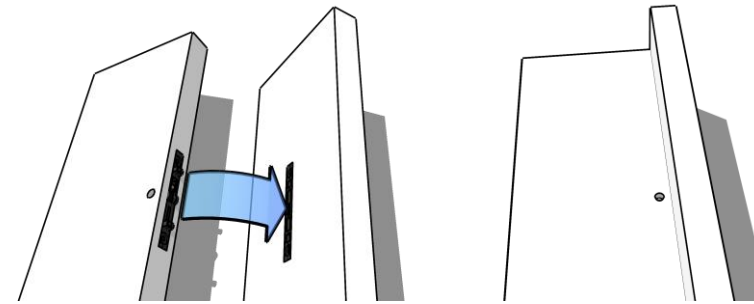

TO ASSEMBLE THIS,
YOU'LL NEED THE
FOLLOWING TOOLS:

4MM LONG ALLEN KEY
6MM ALLEN KEY
(THERE'LL BE ONE OF EACH IN
YOUR TOOL BOX)



Lamello

Unlike traditional cam fixings, the fixings we use are designed not to be seen when the unit is assembled. To fit them, simply align the pair of fixings, and use an allen key in the adjacent hole to join/twist the lever from one into the other.

1

First, fit the bracing panels to the underside of the worksurface using the Lamello fittings (above). We're showing the mid-height bench below which has two panels, but the same principle applies to the low benches (which have just one panel) too.

2

Next, add the side panels with the dark grey side facing inwards. It's sometimes necessary to wiggle the panel a little to get all the Lamellos to line up but when you have, turn the allen key clockwise to lock them in place.

3

Turn the bench upright and screw in the adjustable feet if they haven't already been fitted.

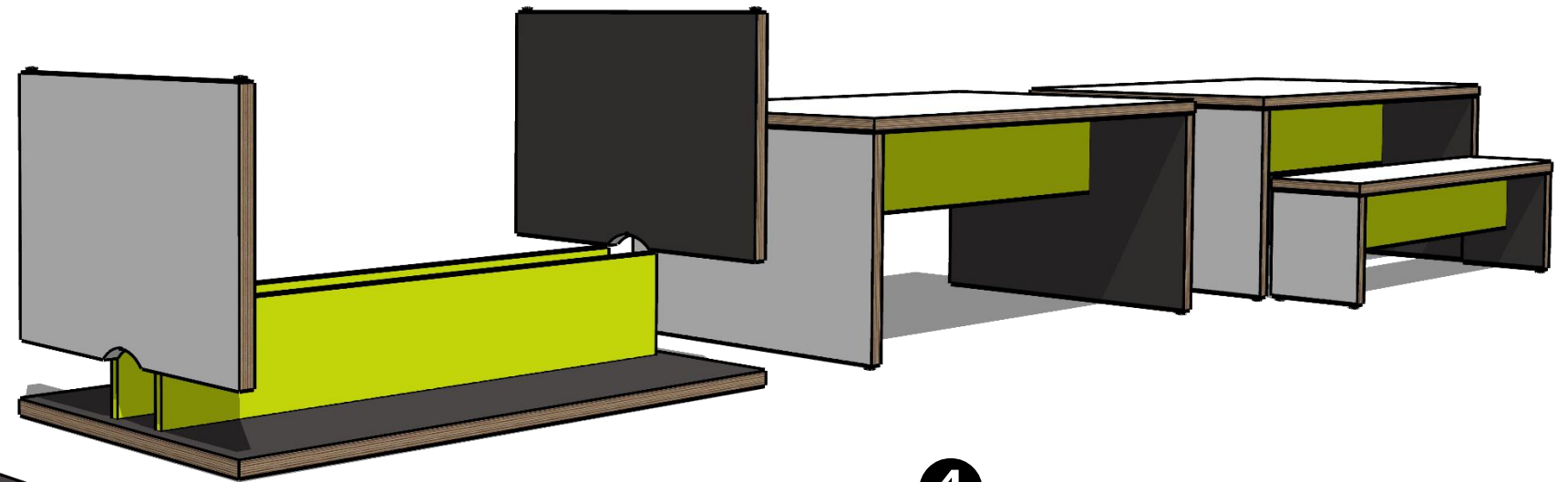
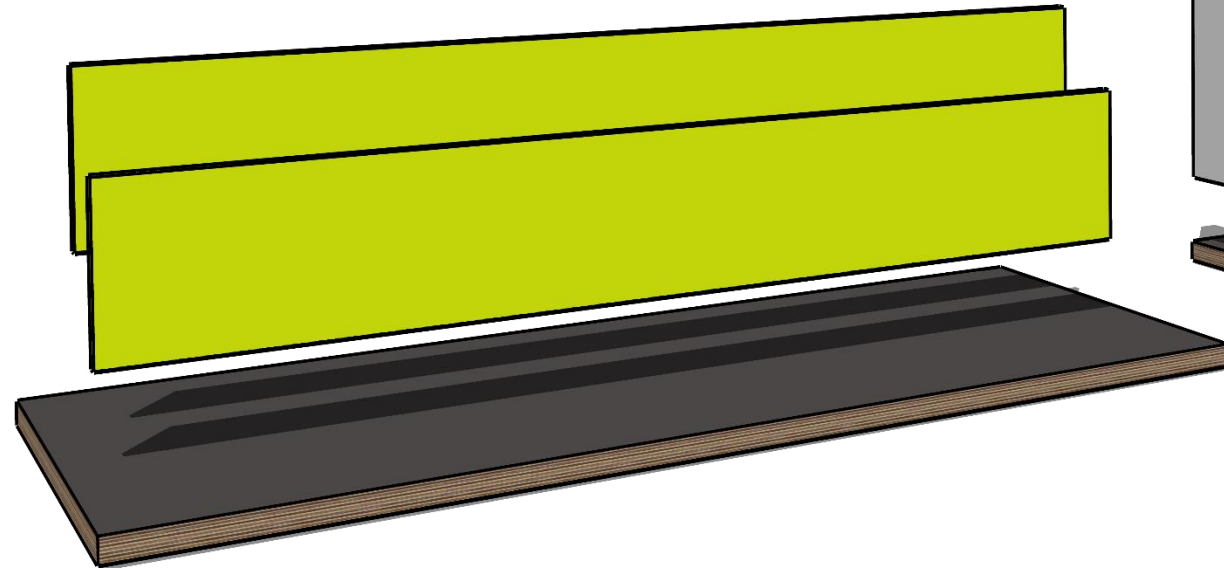

4

Repeat the process for the low benches.

5

For the tall bench, it's easiest to fit the lower anti-tip panel first using the Lamello fixings.

Then add the bracing panel, screwing from the underside, and finally add the worksurface.

Remove the protective film on the LearningSurface® panels. Remember to consult the LearningSurface® care pack to look after the dry-wipe surface.

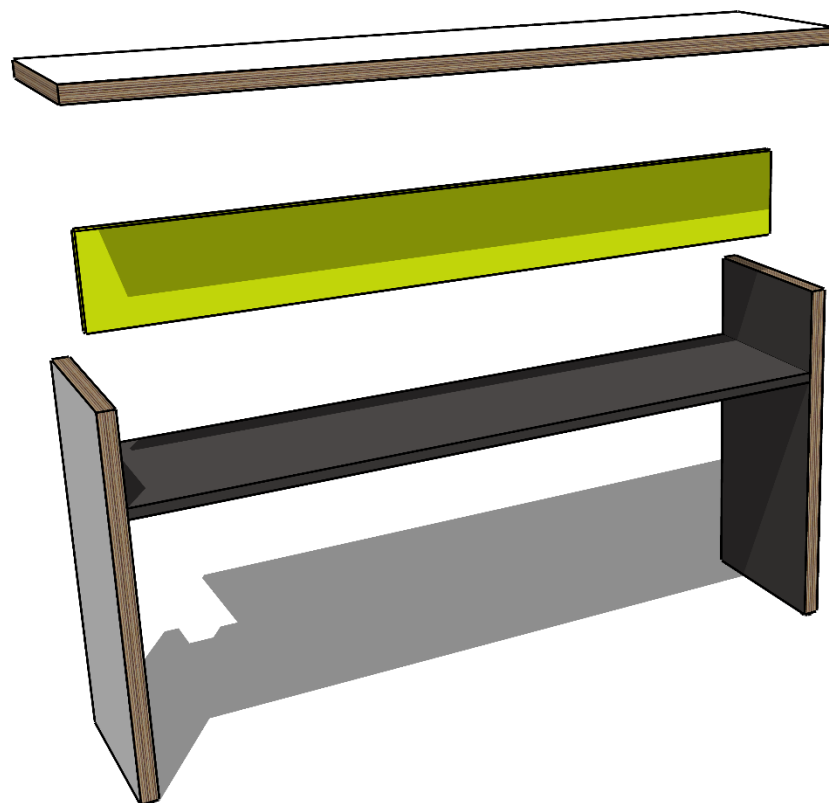

ASSEMBLY INSTRUCTIONS

HEPPELL BENCH

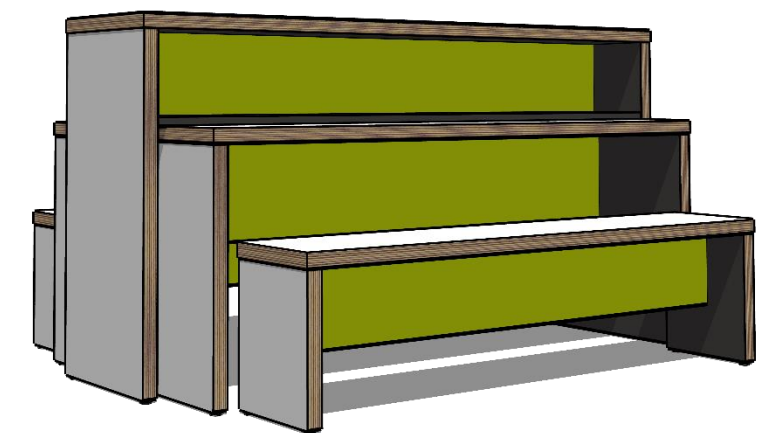

learniture

www.learniture.co.uk
+44 (0) 1491 352152

HEP-INS R109/20