

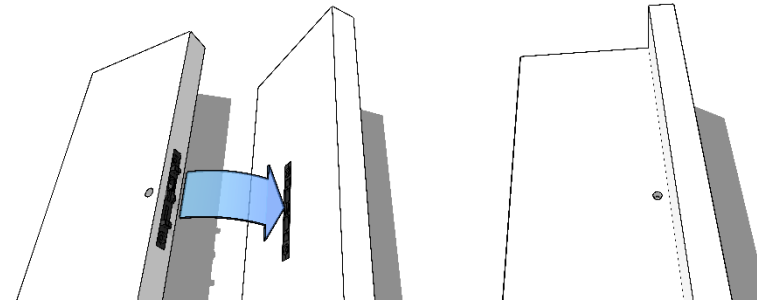

**TO ASSEMBLE THIS,
YOU'LL NEED THE
FOLLOWING TOOLS:**

4MM LONG ALLEN KEY
6MM ALLEN KEY
(THERE'LL BE ONE OF EACH IN
YOUR TOOL BOX)

**YOU COULD USE AN
ELECTRIC DRILL FOR
THE CASTERS**



Unlike traditional cam fixings, the fixings we use are designed not to be seen when the unit is assembled. To fit them, simply align the pair of fixings, and use an allen key in the adjacent hole to join twist the lever from one into the other.

1

First, fit the tray runners to each of the side panels. Make sure you fit the left hand ones and right hand ones on the correct sides (see below)

(you'll find the tray runners and screws in the box with the trays)

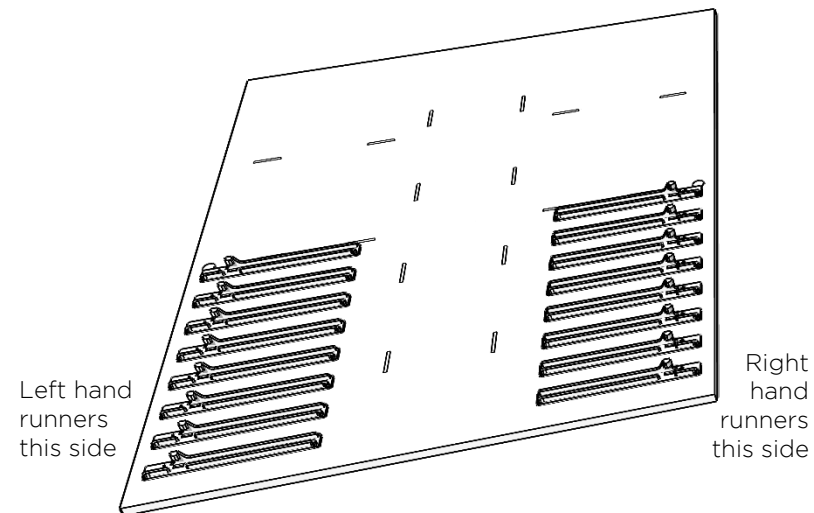

2

Next, add the narrow panels - the long central ones first (make sure the holes for the fixings are to the inside) and then the shelves (with the holes to the underside - ie closest to the trays runners)

Put the metal handle in the hole next to the shallower shelf, and then line up and fix the second side panel.

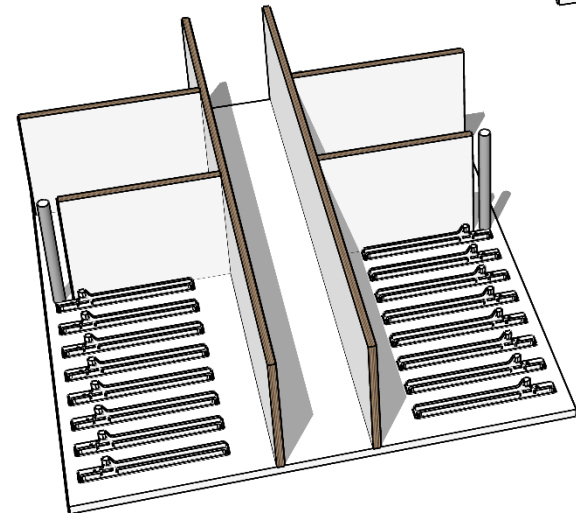

3

Then add the top and bottom panels. The bottom panel has 4 holes in each corner for the casters. Finally fit the casters using the M6 bolts,

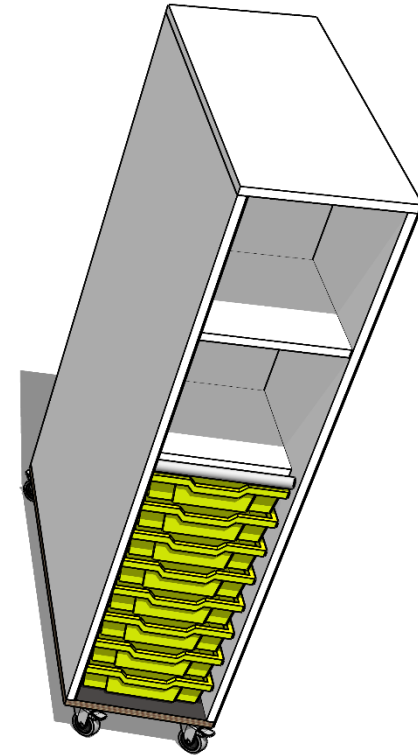
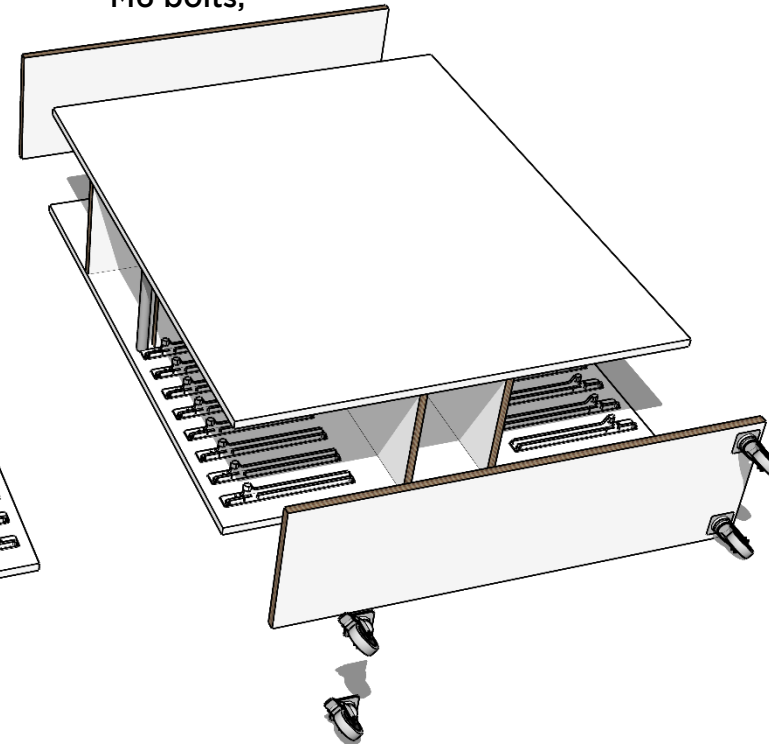

4

Turn the LearningWall onto the casters and add the trays. Remove the protective film on the side panels and the blue film on the edging. Remember to consult the LearningSurface® care pack to look after the dry-wipe surface.

learniture

ASSEMBLY INSTRUCTIONS

LEARNING|WALL

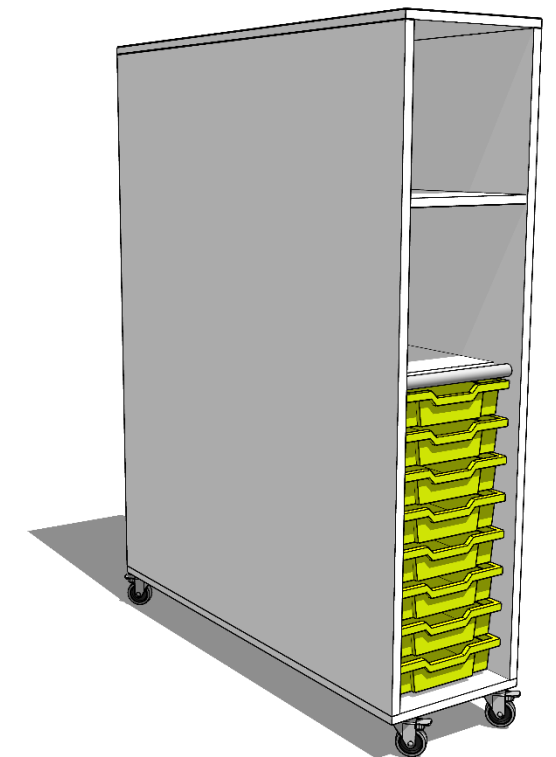

learniture

www.learniture.co.uk
+44 (0) 1491 352152

LWL-INS R109/20