

Open International #EduDesign Challenge #001  
Design a multi-disciplinary post-COVID learning space  
for thirty pupils ages eight and nine.

## PLANNING FOR A COVID AWARE WORLD

The design team at Spaceoasis and Learniture started with a blank sheet of paper for their submission to the A4le Challenge. Here, designer James Clarke describes their rationale.

Of course nobody is going to build brand new learning spaces at a point where we do not know how long, as a society, we will be living with the constraints brought about by the coronavirus pandemic. But if those issues did become long term – the 'new norm' we're all talking about, then what might classrooms look like? That said, the one thing we didn't challenge was that one teacher would need to be able to supervise around 30 learners. The ramifications of suggesting differently would have been significant. This is what we came up with. ■



Special tables allow collaboration whilst ensuring physical distancing

Maximum glazing ensures a teacher can still supervise 30 students



Strong WiFi outdoors as well as projecting onto the back of the glazing allows the outside to become an intrinsic part of the learning space



**“WE USED OUTDOOR TERRACES TO CREATE SPACES FOR PLENARIES AND PRESENTATIONS TO LARGE GROUPS OF STUDENTS”**

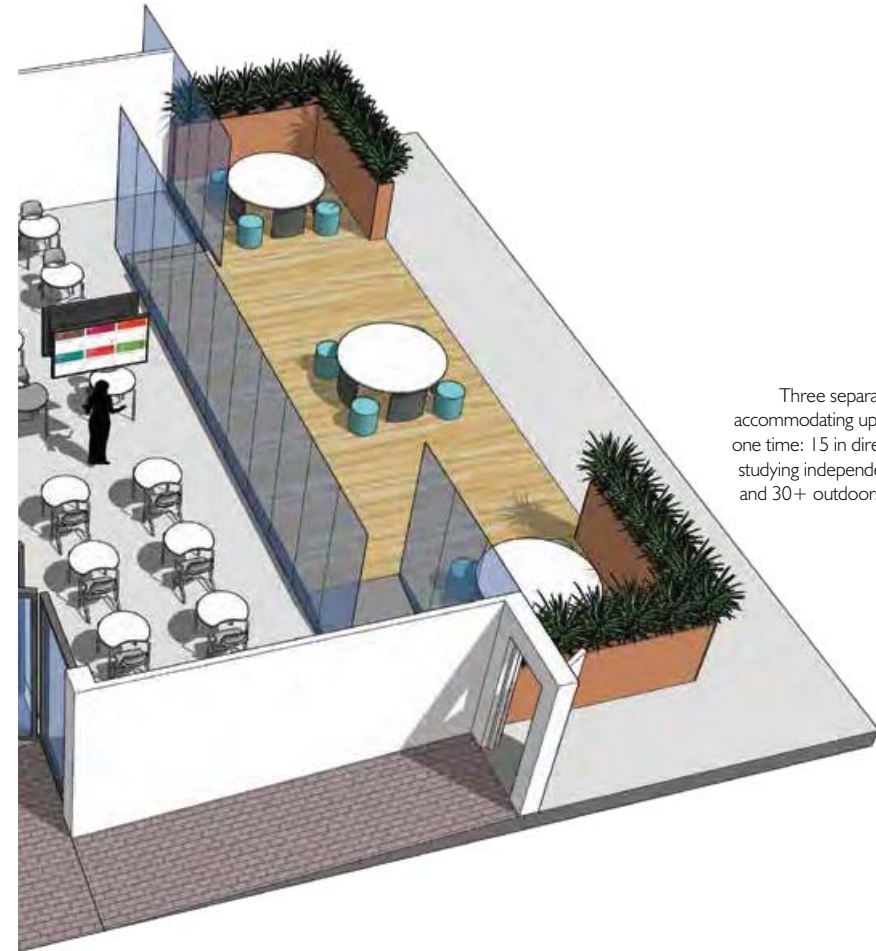
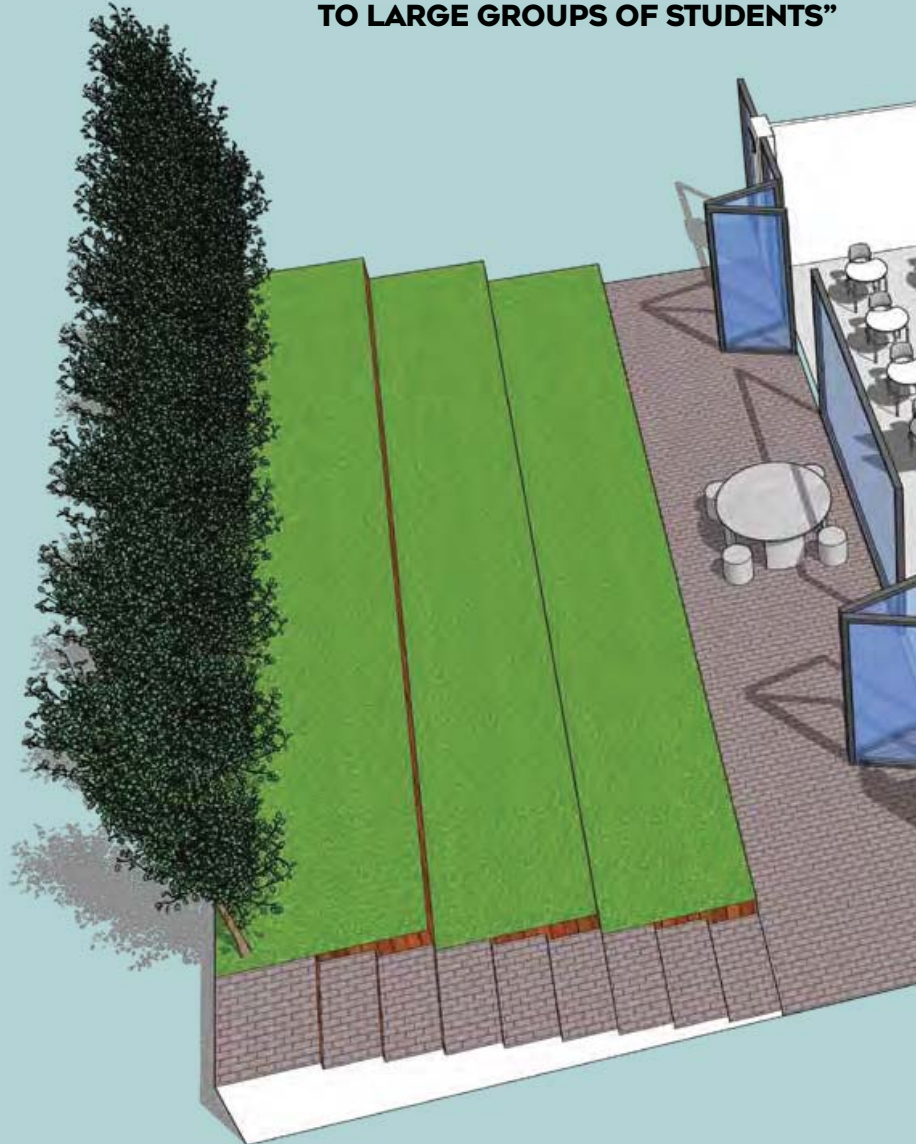

Three separate learning zones accommodating up to 60 learners at one time: 15 in direct instruction; 15 studying independently or in groups and 30+ outdoors on the terraces.

**“WHILST PREVIOUSLY WE’D PREFERRED SQUARER SPACES, WE FOUND THAT NARROW SPACES GAVE CLEARER, PHYSICALLY-DISTANCED CIRCULATION AROUND STUDENTS”**